

How to Use Generalscan Keyboard Pro

Version 1.0

Jun - 22

Table of Contents

Copyright.....	3
Service Information	3
Revision History.....	3
Overview	4
Download	4
Operation	5
Go Select	10
Scanner is in SPP Mode	10
Scanner is in BLE Mode.....	18
Scan QR Code.....	26
Fast Connect.....	35

Copyright

GENERALSCAN reserves the right to make changes to any product to improve reliability, function, or design.

GENERALSCAN does not assume any product liability arising out of, or in connection with, the application or use of any product, circuit, or application described herein.

Service Information

If there is a question with the barcode scanner, you can visit website for the live chat at: www.generalscan.com

Revision History

Version	Date	Description
1.0	Jun-22	Initial Release

Overview

This file is used to introduce how to use Keyboard Pro.

Download

Can search “Generalscan keyboard Pro” in Google play and download.

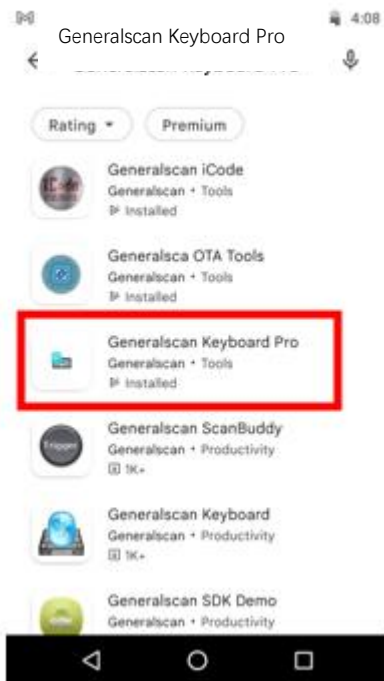

Operation

Step1: Open Generalscan Keyboard Pro APP



When use this first time, should open input method follow the steps below.

Choose GO



Choose Generalscan Keyboard Pro

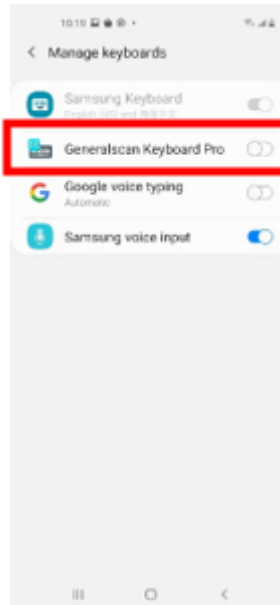

Click OK

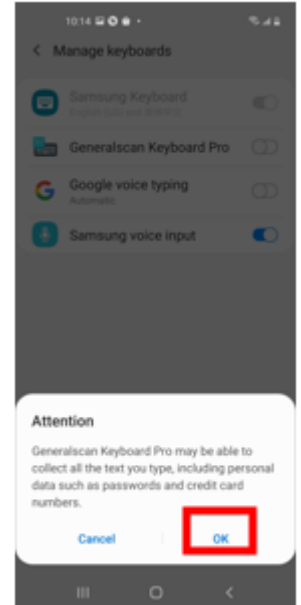

Click OK

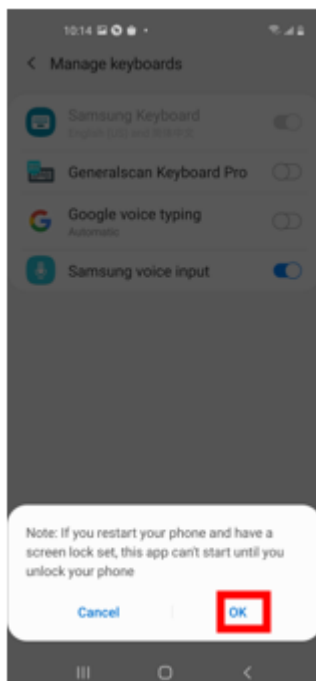

Input method open successfully

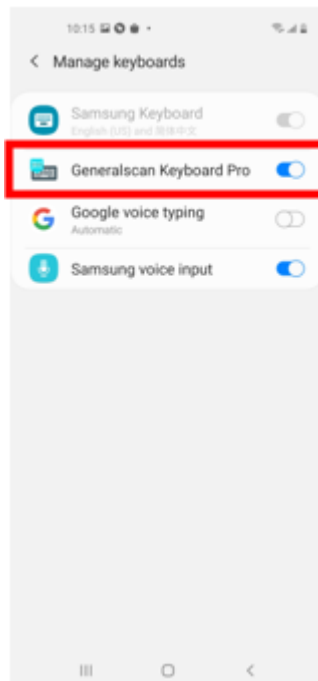

Choose GO



Choose Generalscan Keyboard Pro

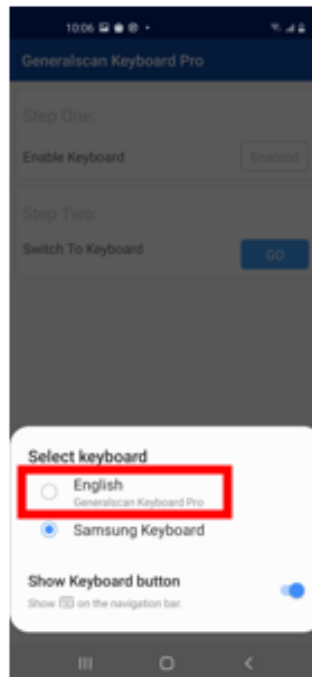

NOTE: If installed Generalscan Keyboard Pro, but didn't start bluetooth, maybe appear conditions as below, just click OK to start blue is ok.

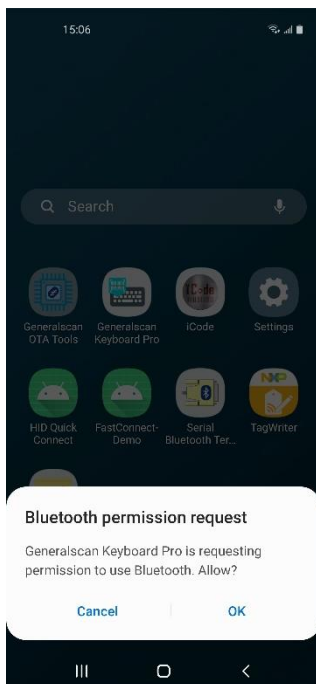

Step2: Click Connect Scanner

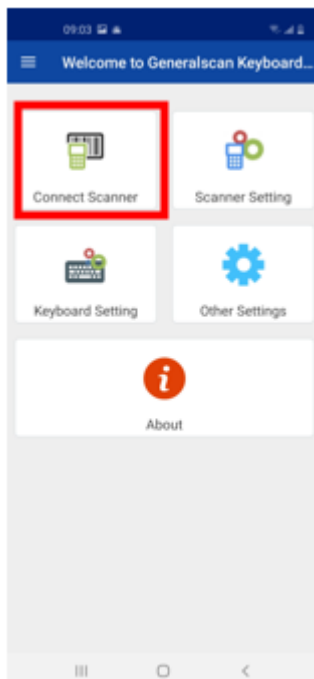

Step3: Open Bluetooth, click Allow

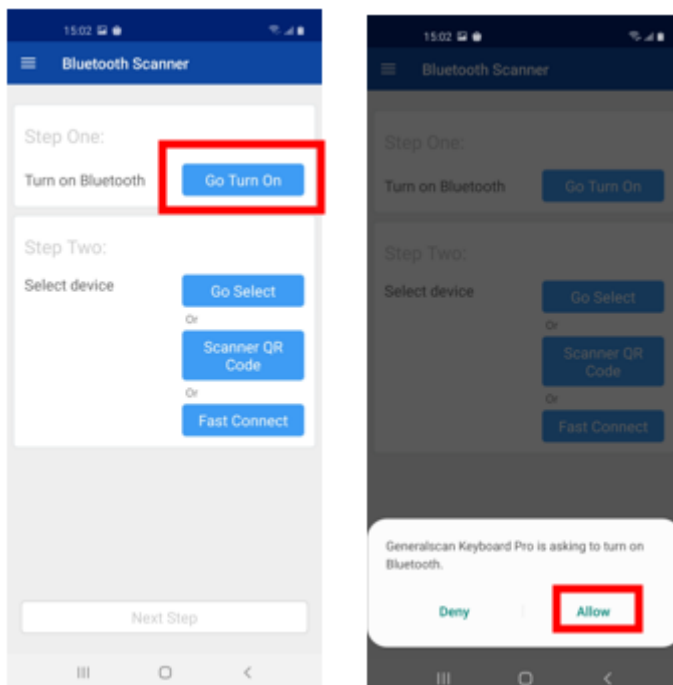

In this interface, we offer three methods of connection: Go Select, Scanner QR Code, Fast Connect

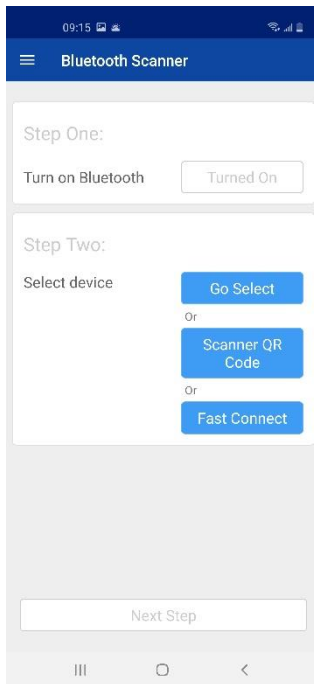

Go Select

Scanner is in SPP Mode

Step1: Scan “Default Factory Setting”, after scanning, the blue indicator light will be in quickly flashing status.

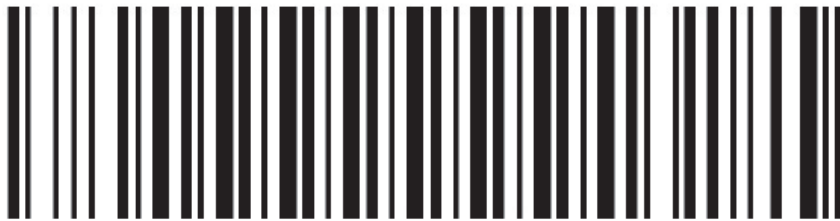

Default Factory Setting

Step2: Scan the barcode of Bluetooth SPP Mode, observe the blue indicator light of the scanner is in flashing slowly status.



Bluetooth SPP Mode

Step3: Click Go Select

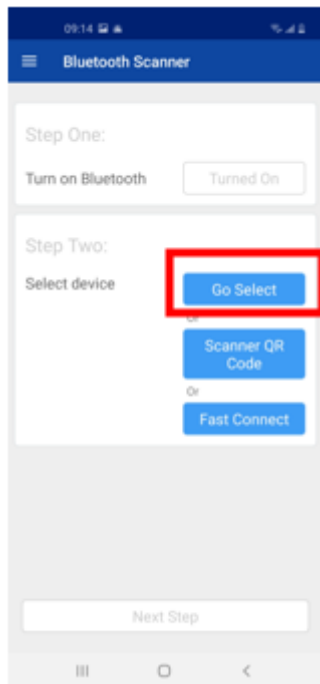

Step4: Choose the Bluetooth name of scanner

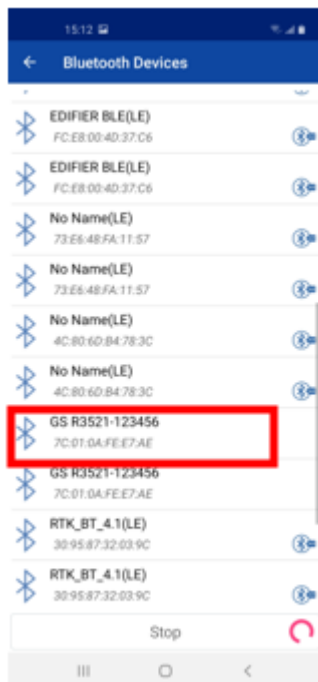

Step5: Pop-up pairing password box, input pair password 1234, click OK.

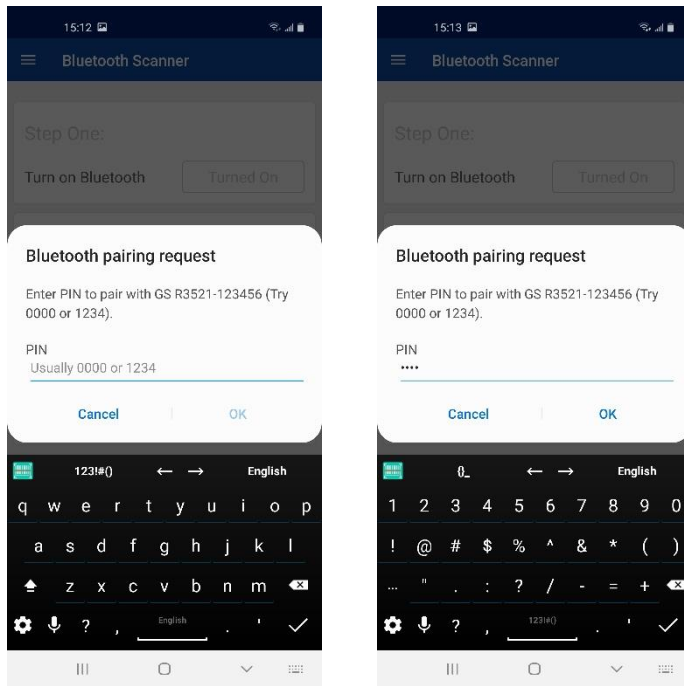

Step6: Click Next Step

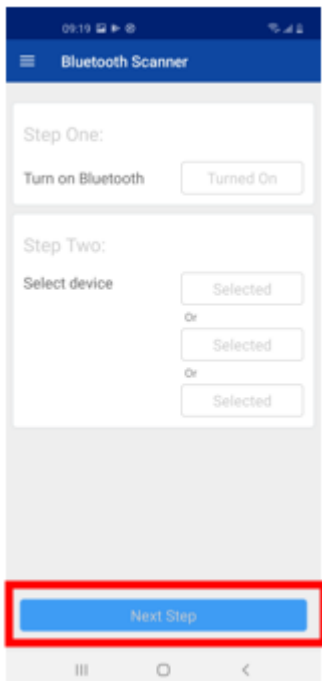

Step7: Enter input interface



Step8: Scan barcode , appear input data

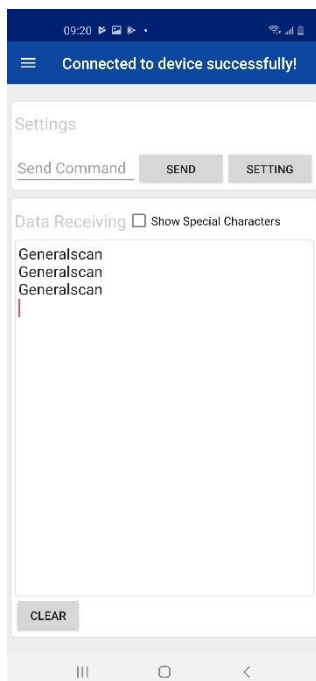

Step 9: Click SETTING, can see many functions are supplied

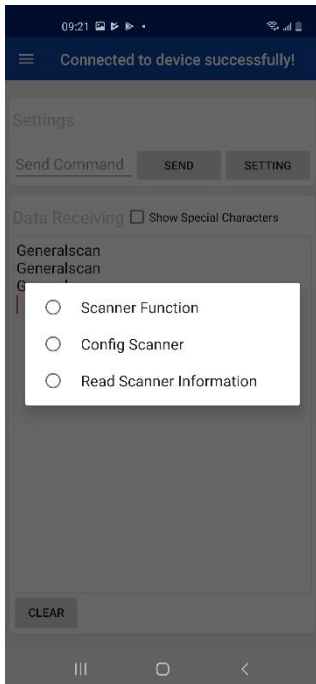

Scanner Function

Config Scanner

Read Scanner Information

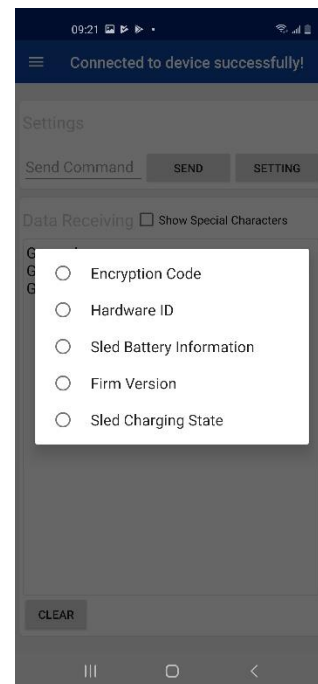
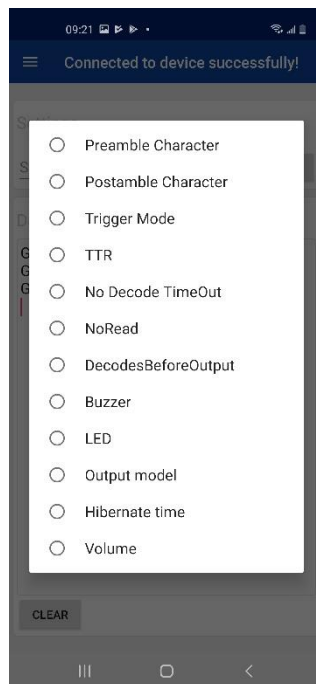
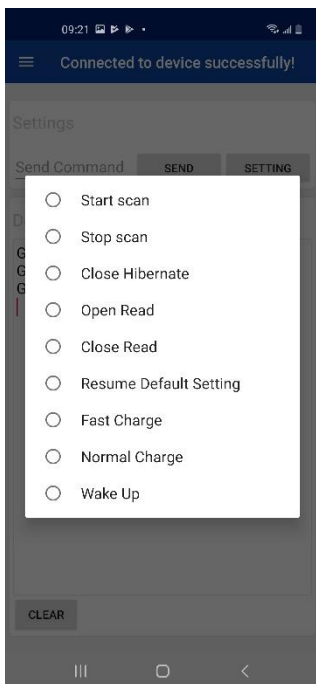

Click Firm Version in Read Scanner Information, can read firmware version information of scanner.



Can input order manually, e.g.: input{G1064}.



Click SEND, can get firmware version information of scanner



Step10: Choose Show Special Characters, can show special character in output data



Step11: Click Clear can delete input data



Step12: Open a text file, scan barcode can get output data

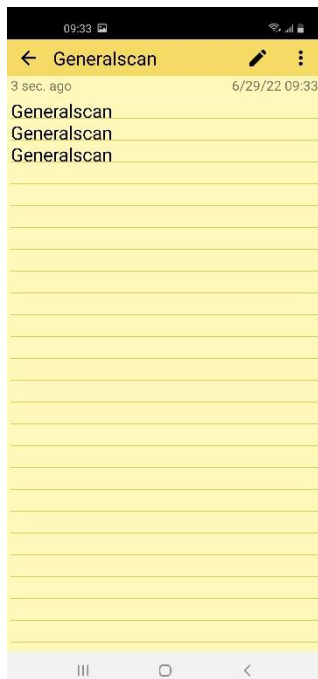

Scanner is in BLE Mode

Step1: Scan “Default Factory Setting” , after scanning, the blue indicator light will be in quickly flashing status.

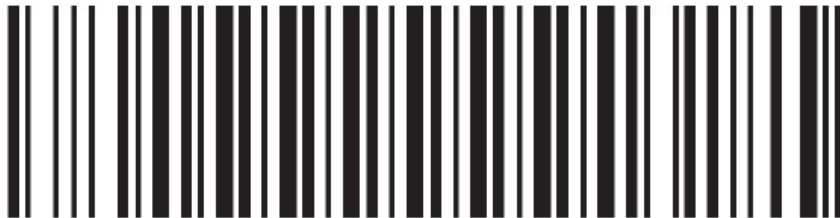

Default Factory Setting

Step2: Scan the barcode of Bluetooth BLE Mode, observe the blue indicator light of the scanner is in two quickly and one slowly flashing status.



Bluetooth BLE Mode

Step3: Click Go Select

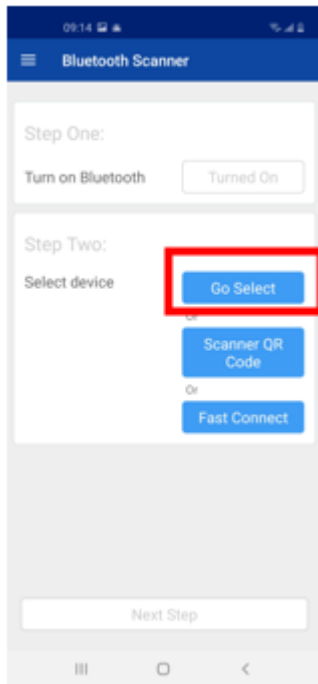

Step4: Choose Bluetooth name of scanner

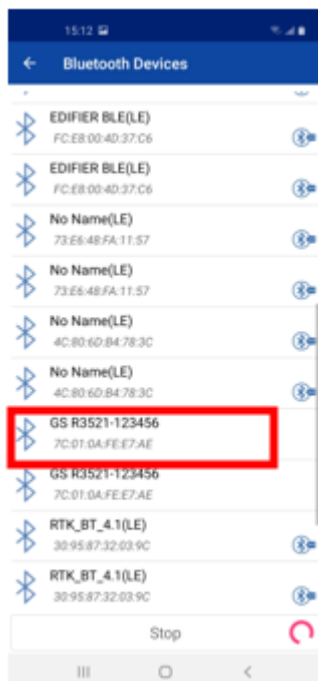

Step5: Click Next Step

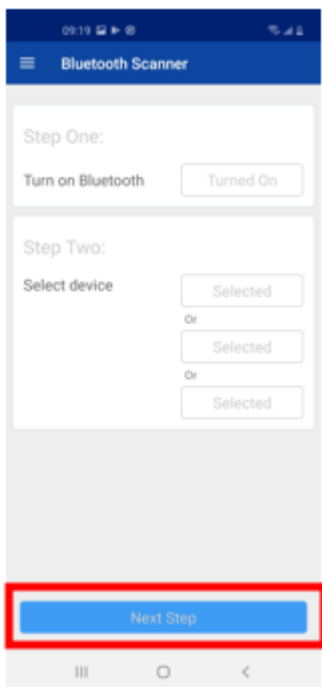

Step6: Enter input interface

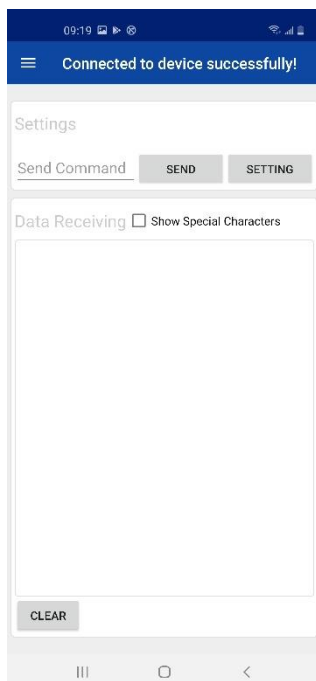

Step7: Scan barcode, appear input data

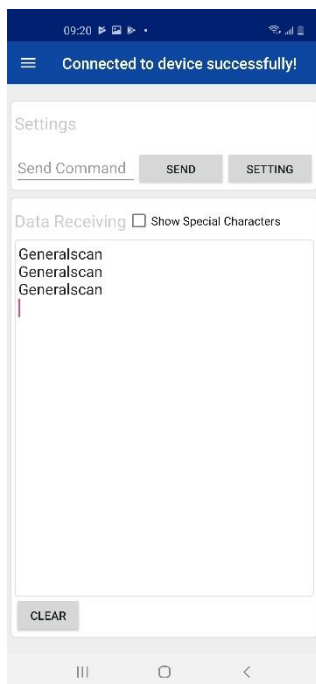

Step8: Click SETTING, can see many functions are supplied

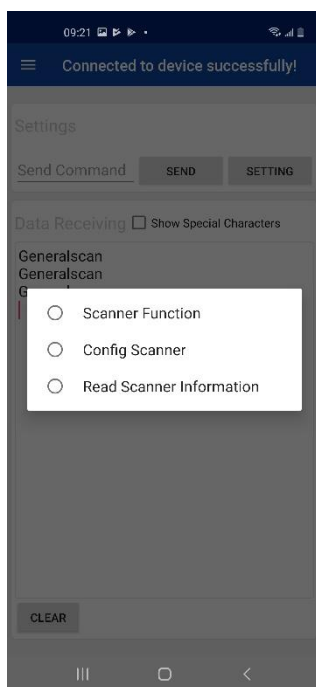

Scanner Function

Config Scanner

Read Scanner Information

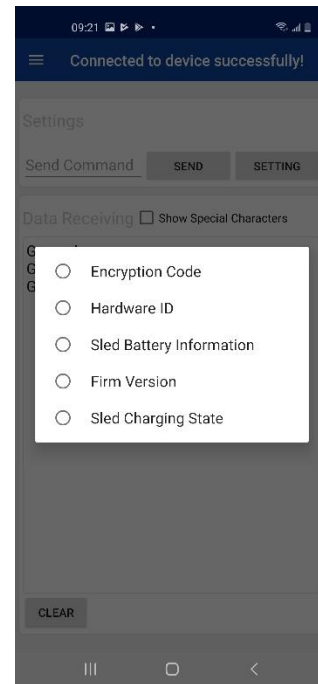
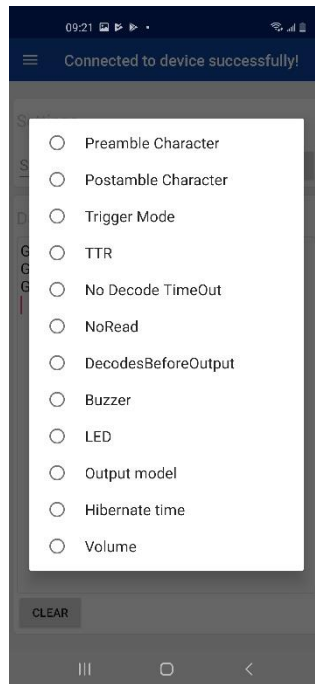
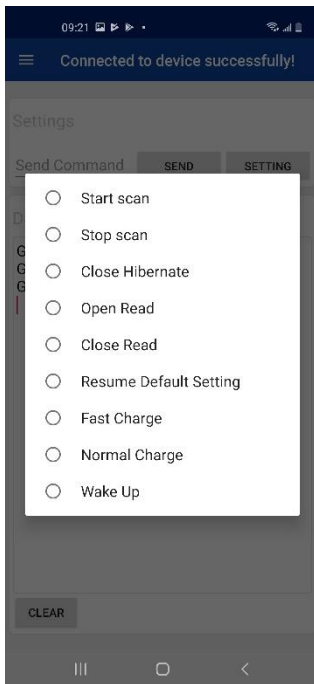

Click Firm Version in Read Scanner Information, can read firmware version information of scanner.



Can input order manually, e.g.: input{G1064}.

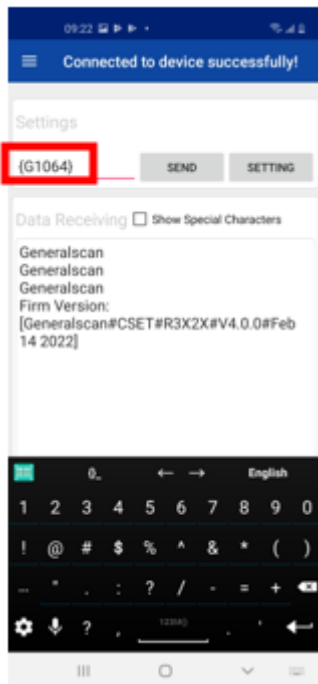

Click SEND, can get firmware version information of scanner



Step9: Choose Show Special Characters, can show special character in output data



Step10: Click Clear, can delete input data



Step11: Open a text file, scan barcode, can get output data

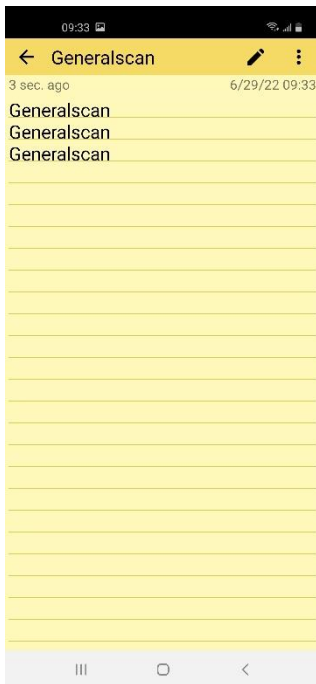

Scan QR Code

Step1: Scan “Default Factory Setting”, after scanning, the blue indicator light will be in quickly flashing status.

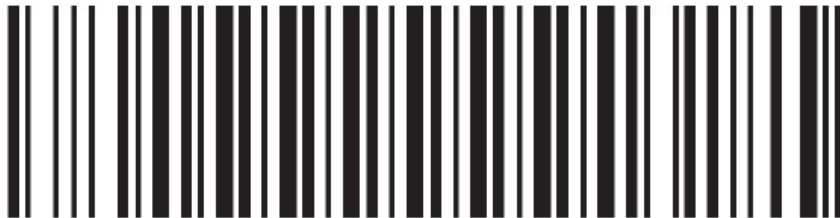

Default Factory Setting

Step2: Scan the barcode of Bluetooth SPP Mode, observe the blue indicator light of the scanner flashes slowly.



Bluetooth SPP Mode

Step3: Click Scan QR Code

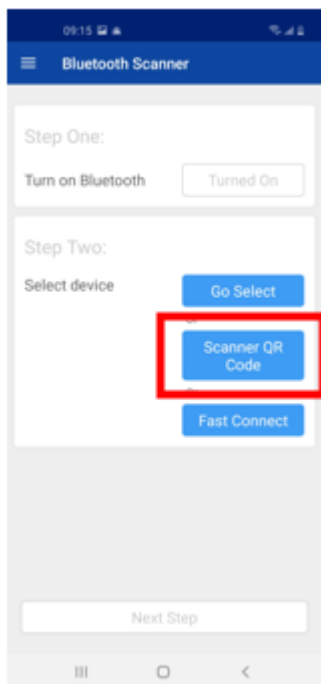

Step4: Use mobile phone to scan the Bluetooth address of scanner.



7C:01:0A:FE:E7:AE

Can get Bluetooth address of scanner by scanning the barcode below.



Step5: Pop-up pairing password box, input pair password 1234, click OK

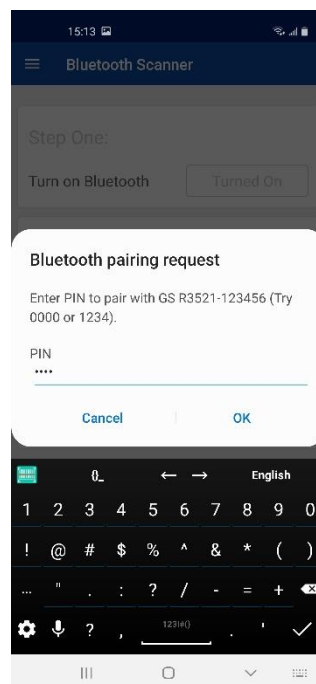
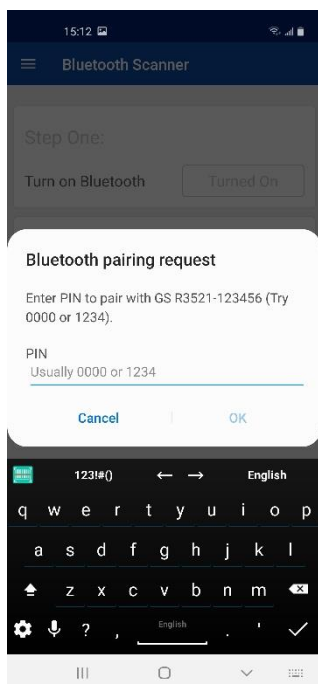

Step6: Click Next Step

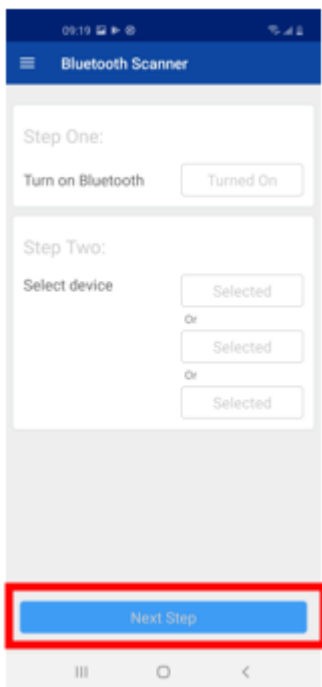

Step7: Enter input interface

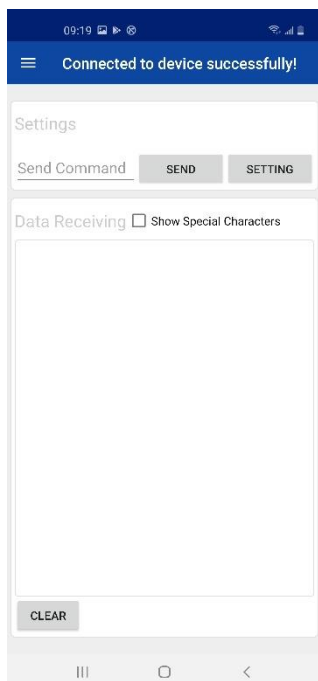

Step8: Scan barcode, appear input data

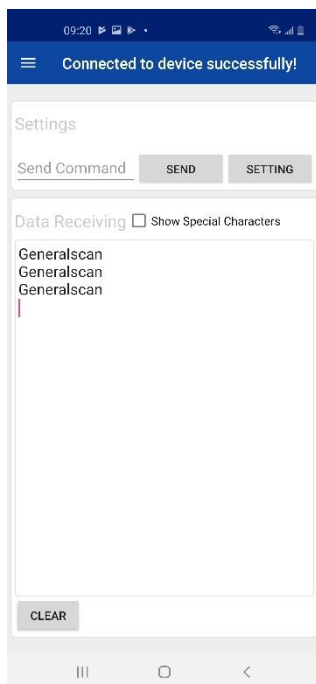

Step9: Click SETTING, can see many functions are supplied.

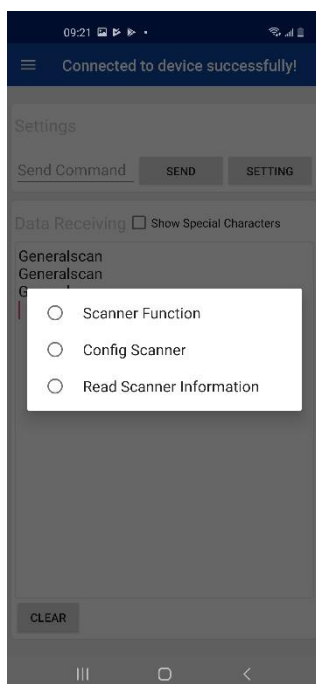

Scanner Function

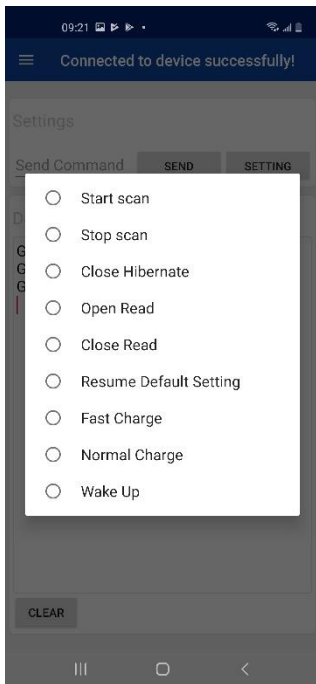

Config Scanner

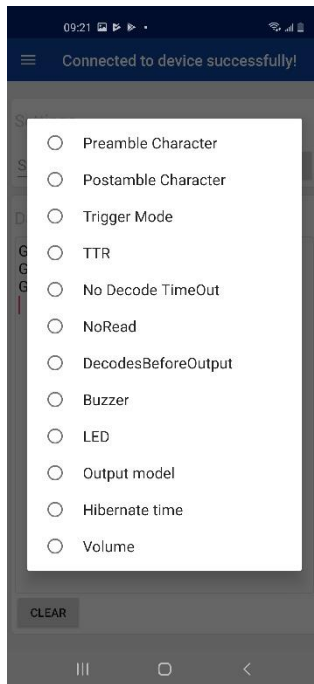

Read Scanner Information

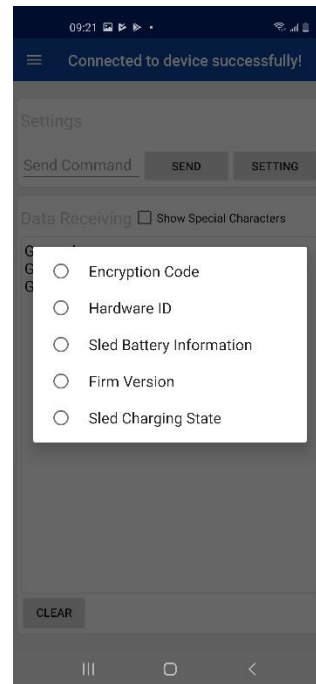

Click Firm Version in Read Scanner Information, can read firmware version information of scanner.

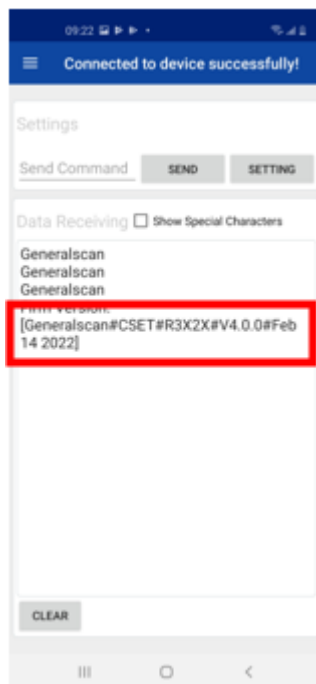

Can input order manually, e.g.: input{G1064}.

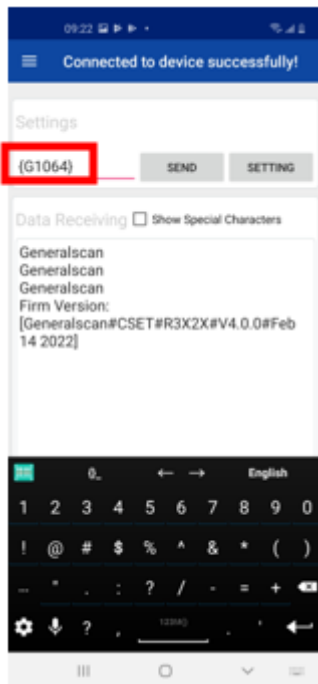

Click SEND, can get firmware version information of scanner.



Step10: Choose Show Special Characters, can show special character in output data.



Step11: Click Clear, can delete input data



Step12: Open a text file, scan barcode, can get output data

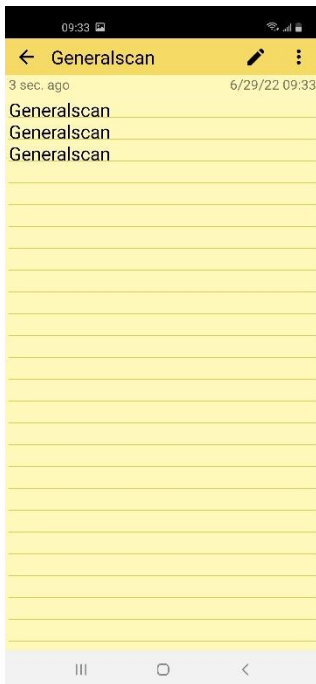

Fast Connect

Step1: Scan “Default Factory Setting”, after scanning, the blue indicator light will be in quickly flashing status.

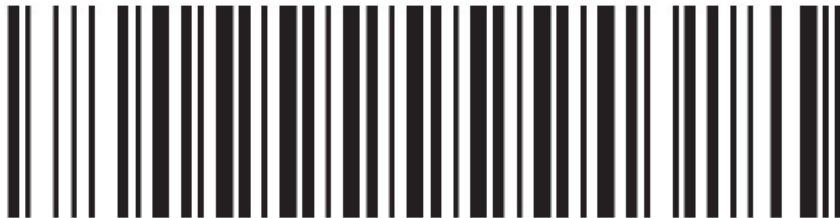

Default Factory Setting

Step2: Scan the barcode of Bluetooth SPP Master Mode, observe the blue indicator light of the scanner is in three quickly and one slowly flashing status.



Bluetooth SPP Master Mode

Step3: Click Fast Connect

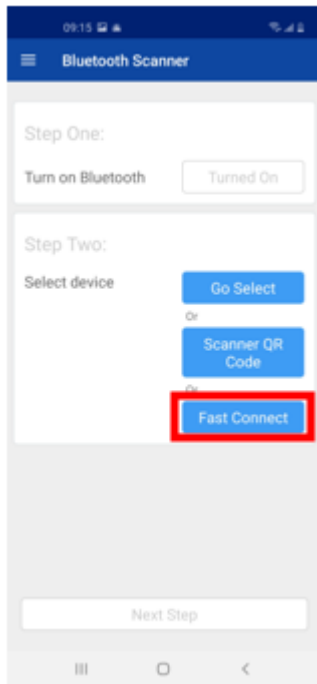

Step4: Click OK

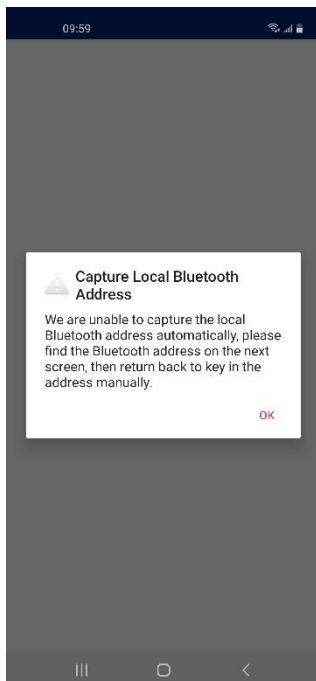

Step5: Click Status

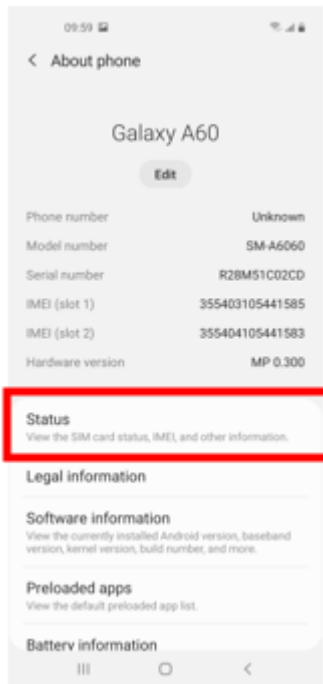

Step6: Check Bluetooth address of mobile phone

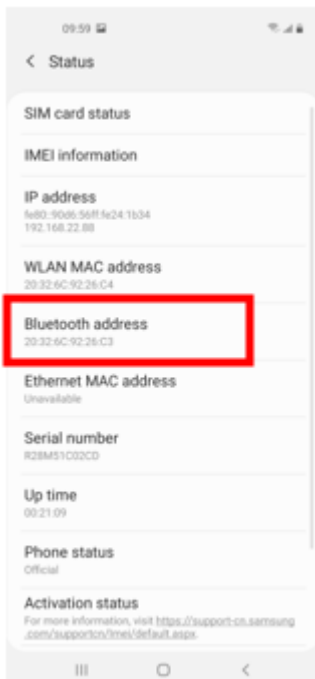

Step7: Click back, till back to the interface as below.

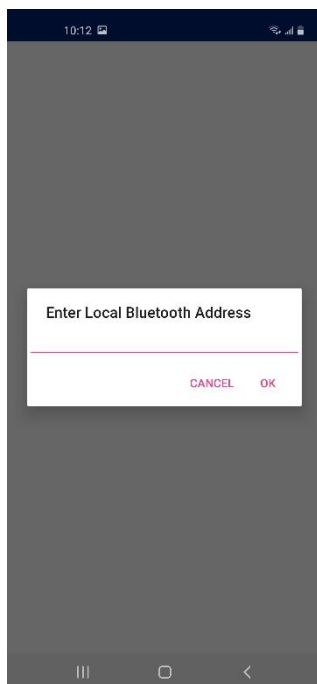

Step8: Input the information of mobile phone Bluetooth address checked just now to the dialogue box, click OK.

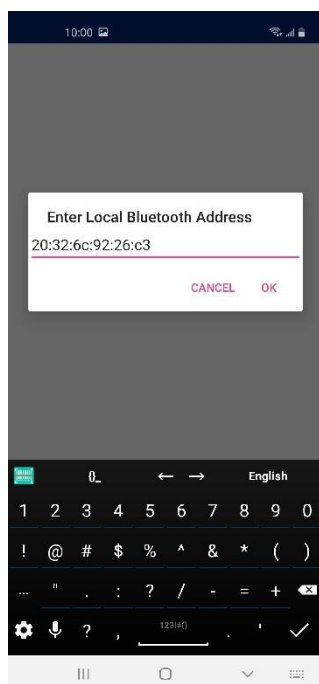

Step9: Use scanner to scan the barcode that mobile phone created



Step10: Pop-up pairing password box, input pair password 1234, click OK

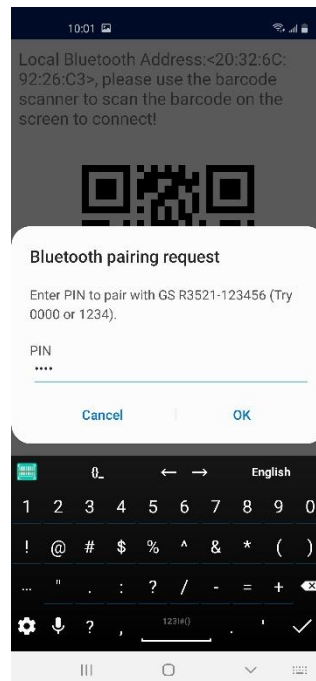
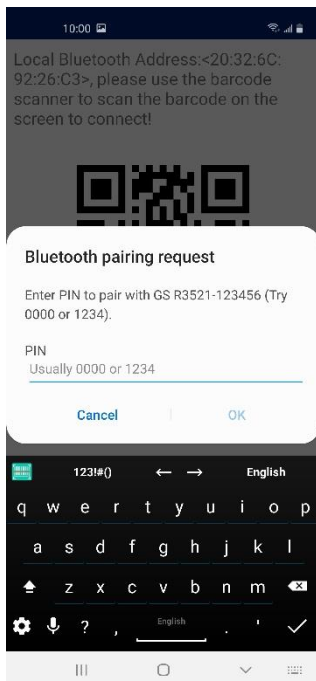

Step11: Click Back



Local Bluetooth Address:<20:32:6C:
92:26:C3>, please use the barcode
scanner to scan the barcode on the
screen to connect!



Step12: Click Back



Step One:

Turn on Bluetooth

Turned On

Step Two:

Select device

Go Select

Or

Scanner QR
Code

Or

Fast Connect

Next Step



Step13: Click Scanner Setting

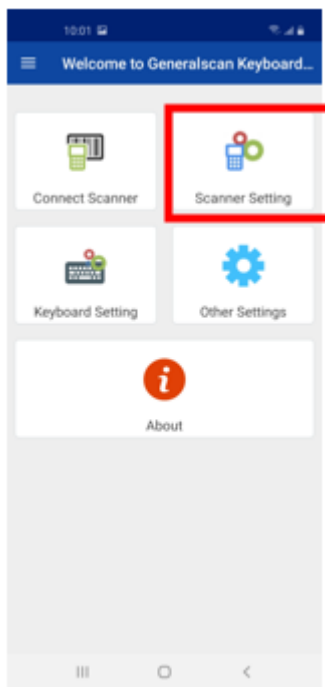

Step14: Enter input interface

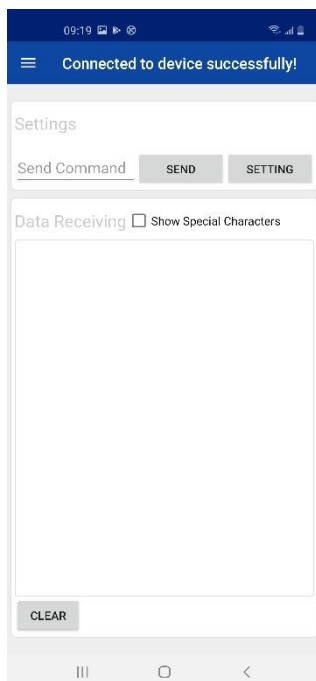

Step15: Scan barcode, appear input data

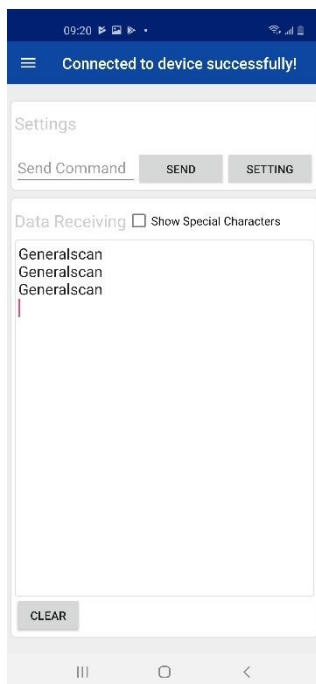

Step16: Click SETTING, can see many functions are supplied.

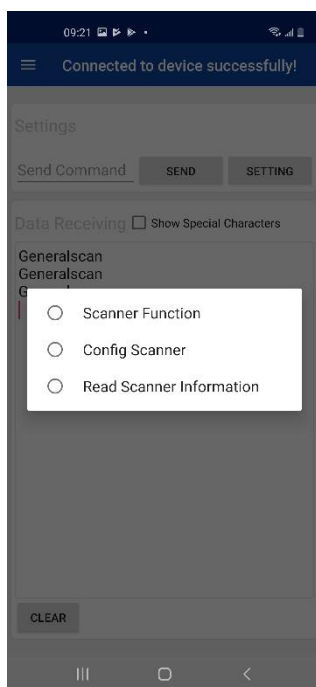

Scanner Function

Config Scanner

Read Scanner Information

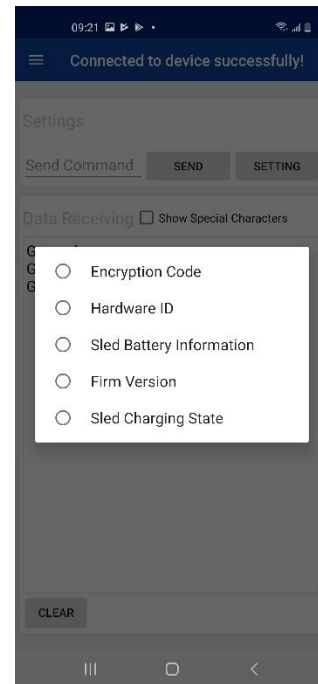
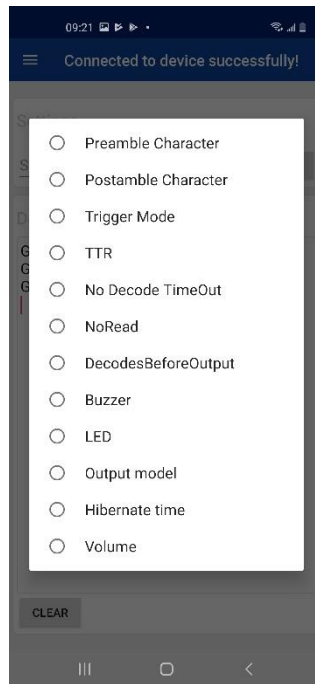
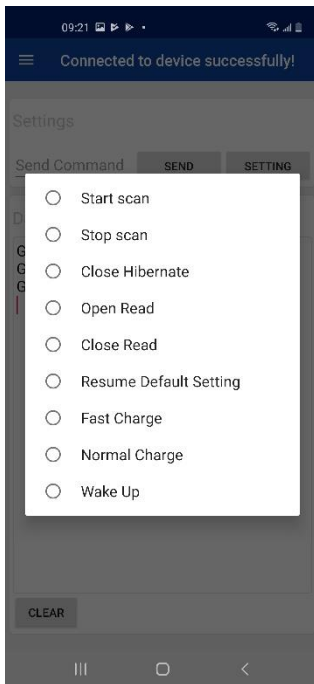

Click Firm Version in Read Scanner Information, can read firmware version information of scanner.

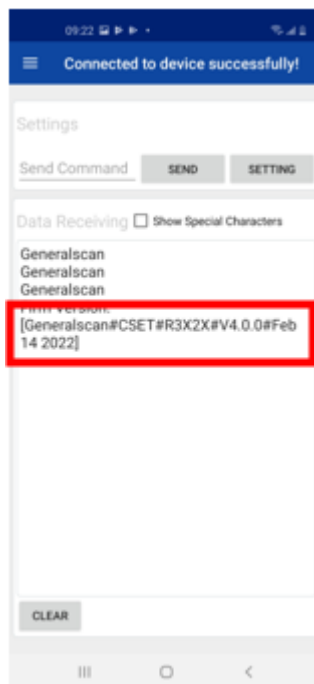

Can input order manually, e.g.: input{G1064}.

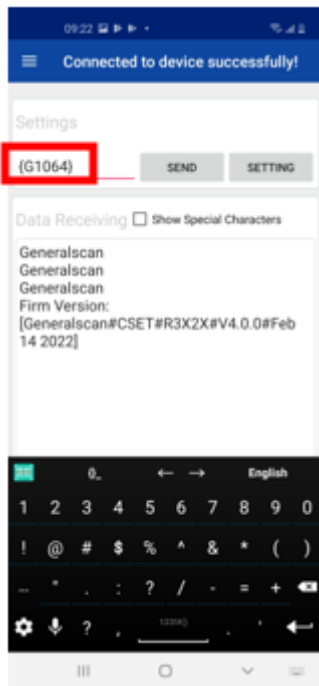

Click SEND, can get firmware version information of scanner



Step17: Choose Show Special Characters, can show special character in output data.



Step18: Click Clear, can delete input data



Step19: Open a text file, scan barcode, can get output data

